

## Method of Sections

**Problem Statement:** Determine the force in each members BC, CG, and FG of the truss, and indicate whether the members are in tension or compression.

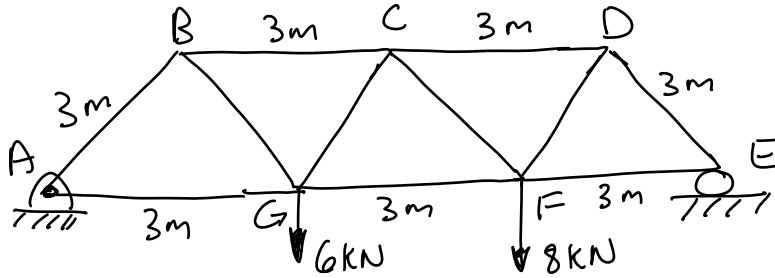

- 1.) Determine the support reactions if possible.
- 2.) Make a cut through the truss members of interest.
- 3.) Enforce equilibrium on one of the sections.

4.) Make additional cuts or use the Method of Joints to find the force in additional truss members.